

LEGAL DESCRIPTION
ALL OF SECTION 8, TOWNSHIP 20 NORTH, RANGE 15 EAST, W.M.,
KITITITAS COUNTY, STATE OF WASHINGTON.

- SURVEY NOTES:**
- ALL BEARINGS AND DISTANCES ARE WASHINGTON STATE PLANE COORDINATE GRID VALUES (SOUTH ZONE - NAD 83/91) BASED ON THE KITITITAS COUNTY GPS NETWORK, USC&GS MONUMENTS AND USFS - WENATCHEE NATIONAL FOREST GPS MONUMENTS. THE COMBINED FACTOR USED FOR THIS PROJECT IS 0.9998681.
 - THE CONTROL SURVEY WAS PERFORMED IN OCTOBER, 1996 AND MAY THROUGH NOVEMBER, 1997 WITH A THREE SECOND TOTAL STATION. CORNER TIES AND ADDITIONAL CONTROL WAS RUN IN JULY THROUGH NOVEMBER, 1997 USING STATIC & REAL TIME KINEMATIC GPS METHODS BASED ON THE KITITITAS COUNTY CONTROL NETWORK IN CONJUNCTION WITH THE PREVIOUSLY ESTABLISHED NETWORK SET BY EASTSIDE CONSULTANTS. ALL TRAVERSES EXCEEDED THE MINIMUM ACCURACY STANDARDS AS SET FORTH BY WAC 332-130.
 - THE PURPOSE OF THIS SURVEY IS TO SEGREGATE TAX PARCELS IN SECTION 8. THE SEGREGATIONS SHOWN HEREON REFLECTS SPLITS FROM INTERVENING OWNERSHIPS AND LOT SEGREGATIONS OF 20 ACRES OR MORE. ALL EASEMENTS, ENCUMBRANCES AND ENCROACHMENTS ARE NOT SHOWN ON THIS SURVEY.

GLO HISTORY

THE SOUTH, WEST, AND A PORTION OF THE EAST BOUNDARY OF TOWNSHIP 20 NORTH, RANGE 15 EAST WAS ORIGINALLY ESTABLISHED BY DEPUTY SURVEYOR EDWIN RICHARDSON UNDER GLO CONTRACT No.285, DATED NOVEMBER 27 1880. HE THEN SUBDIVIDED THE TOWNSHIP, WITH THE EXCEPTION OF SECTIONS 1 THROUGH 6 AND SECTIONS 11 AND 12, AND THE NORTH HALF OF SECTIONS 13 AND 14. HE COMPLETED HIS SURVEY IN MARCH OF 1881. IN 1903 WORKING UNDER SPECIAL INSTRUCTIONS MOSES M. EMERSON RETRACED A PORTION OF THE ORIGINAL SUBDIVISION PRIOR TO COMPLETING THE TOWNSHIP SUBDIVISION.



EASEMENT PROVISIONS

60' ACCESS EASEMENTS TO A PUBLIC RIGHT OF WAY FOR EACH PARCEL WILL BE GRANTED ALONG EXISTING ROADS OR ALONG PROPERTY BOUNDARIES AFTER RECORDING OF THE SEGREGATION SURVEY.

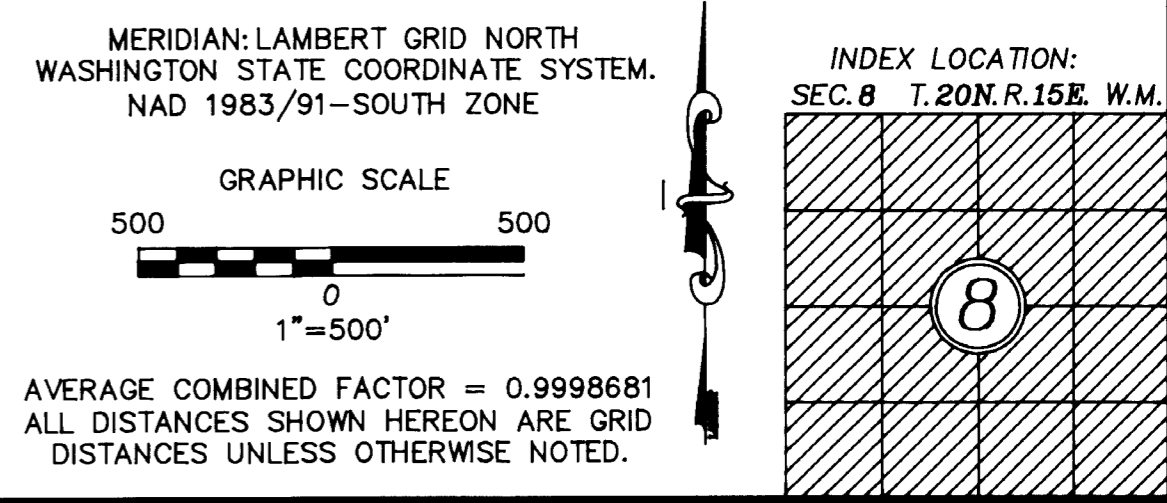

NOTE

THESE SEGREGATIONS ARE PREPARED IN CONFORMANCE WITH THE PROVISIONS OF KITITITAS COUNTY SUBDIVISION CODE, SECTION 16.04.020(1).

RECORDER'S CERTIFICATE 149803060013

Filed for record this 6th day of March 1998 at 11:32 AM in book 13 at page 8 at the request of ROBERT J. BOGDON, Surveyor's Name

Patie Mgr.
Beverly Allenbaugh Supt. of Records

SURVEYOR'S CERTIFICATE

This map correctly represents a survey made by me or under my direction in conformance with the requirements of the Survey Recording Act at the request of PLUM CREEK TIMBER COMPANY in FEB. 1998.

Eastside Consultants, Inc.
Certificate No. 33487

EASTSIDE CONSULTANTS, INC.

ENGINEERS-SURVEYORS
516 EAST FIRST
CLE ELUM, WA 98922

PHONE: (509)874-7433
FAX: (509)874-7419

TRACT SEGREGATION PREPARED FOR PLUM CREEK TIMBER COMPANY		
KITITITAS COUNTY		WASHINGTON
DWN BY R. BOGDON	DATE 2/98	JOB NO. 97507
CHKD BY R. KITZ	SCALE 1"=500'	SHEET 1 OF 1